



# Cambridge Market Square Project

## Concept Design: Key Design Elements Summary

Public Consultation

17.05.2021

LD&DESIGN

# Content

<b>1.0 New surface treatment</b>	<b>3</b>
To create a single unified surface across the entire square, which will be to modern accessibility standards, and include the restoration and repair of the listed granite setts (cobble). A reduction in the width of Market Hill roadway to help make the area more user-friendly for visitors on foot	
<b>2.0 New improved market layout</b>	<b>5</b>
Based on the re-alignment of stalls from a north-south to an east-west orientation, thereby improving permeability of the market for shoppers and creating increased space for seating and tables and chairs; and for outdoor events and activities	
<b>3.0 Market Stall design</b>	<b>8</b>
New, durable and demountable market stall design	
<b>4.0 Street Furniture and Seating</b>	<b>12</b>
Additional seating, benches and tables for eating	
<b>5.0 Utilities</b>	<b>15</b>
A new underground waste management system, improved toilets and storage for stallholders	

**LDĀ DESIGN**  
Lead Design Consultant, Public Realm  
Design and Market Masterplaning

**QUARTERBRIDGE**  
Lead Market Consultant

**NEUBAU**  
Market Stall Architecture

 **Stantec**  
Transport Consultant

  
Lighting Design

**Turley**  
Heritage Consultant

# 1.0 New surface treatment

To create a single unified surface across the entire square, which will be to modern accessibility standards, and include the restoration and repair of the listed granite setts (cobble)

Page 3

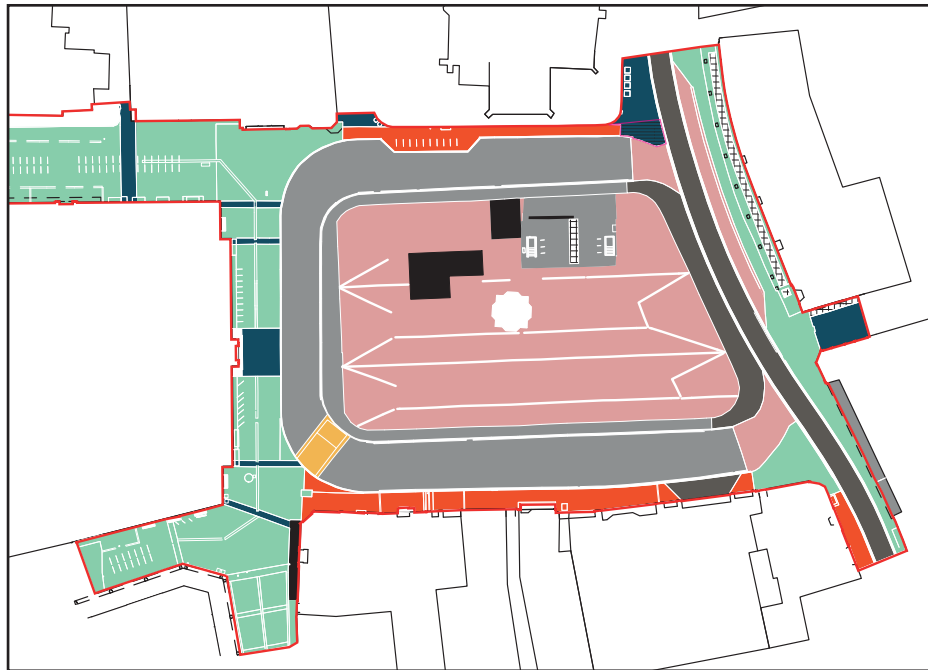

## Existing

- |                                 |                      |
|---------------------------------|----------------------|
| Existing                        | Concrete flag paving |
| Setts                           | Asphalt              |
| Yorkstone flags                 | Concrete             |
| Block paving                    | Trial paving area    |
| Mixed block and concrete paving | Lightwells           |

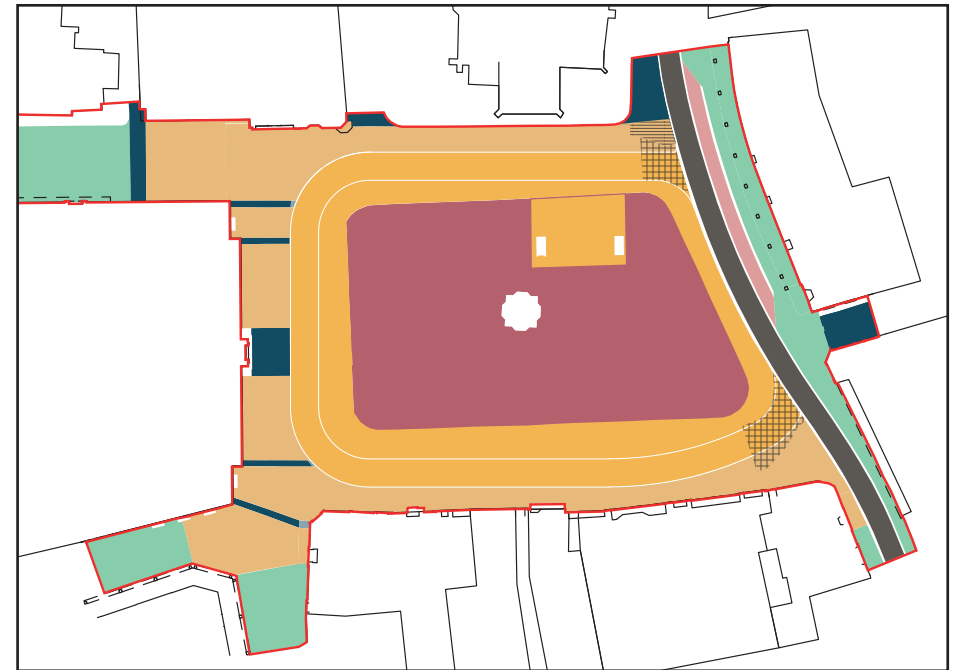

## Proposed

- |  |  |                                   |
|--|--|-----------------------------------|
| Existing   | Existing Sandstone flagstones retained           | Existing concrete paving retained |
| Existing setts retained  | Existing Sandstone flagstones removed and reused | Proposed paving Phase 1           |
| Existing setts removed and reused elsewhere  | Existing Sandstone flagstones reused             | Proposed paving Phase 2           |
| Existing setts removed, treated and relaid (incorporating a percentage of reclaimed setts) | Existing block paving retained                   |                                   |

A reduction in the width of Market Hill roadway to help make the area more user-friendly for visitors on foot

Page 4

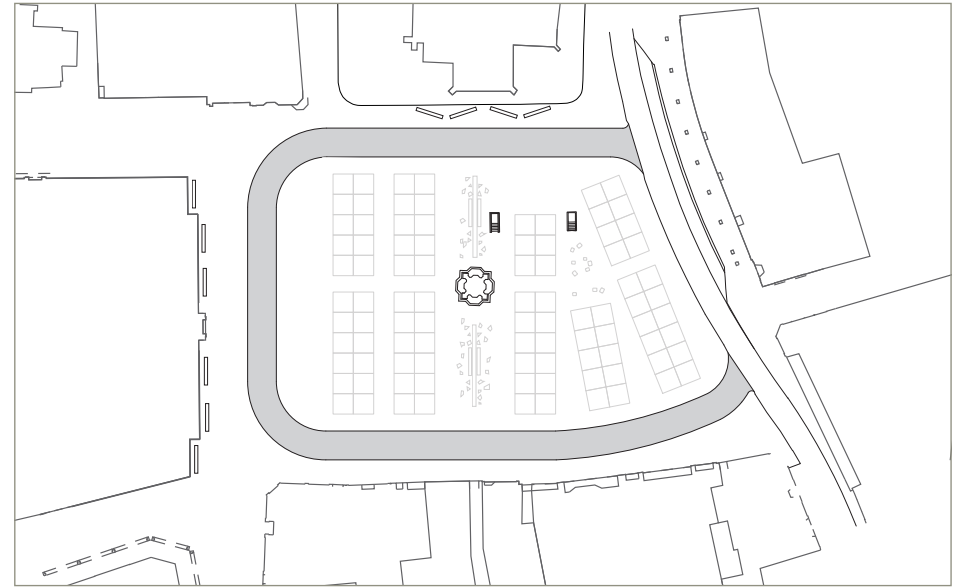
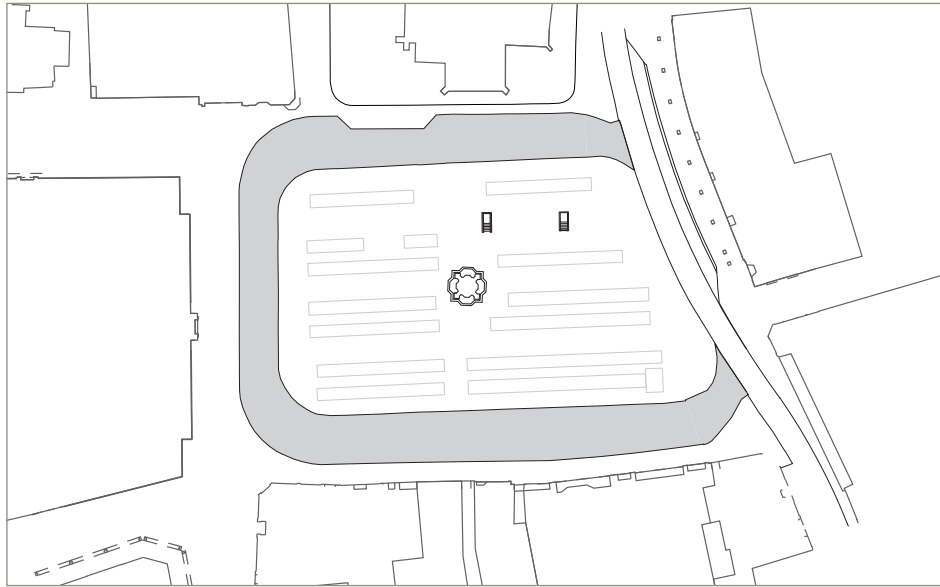

### Existing

The existing road surrounding the market varies in width at different parts of the road. The kerbs are typically around 100mm in height and there is no designated parking around the square apart from a small taxi rank in front of Great St Mary's Church.

### Proposed

The proposed road layout will consistently be 4.25m all the way around the square and thereby aid efficiency and improve ease of accessibility for pedestrians, cyclist and motor vehicles within the Market Square. The proposal reduces the amount of road surface, thereby increasing the pedestrian area and it simplifies the road by removing some of the existing lay-by's and widening the footways around the square.

To provide a more accessible and inclusive pedestrian prioritised space the drop kerbs will be removed and the narrowed road raised, bringing the road height up to reduce the kerb height to 25mm. The road will be designed with new surface treatments to replace uneven surfaces.

## 2.0 New Market Layout

Based on the re-alignment of stalls from a north-south to an east-west orientation, thereby improving permeability of the market for shoppers and creating increased space for seating and tables and chairs; and for outdoor events and activities

Page 5

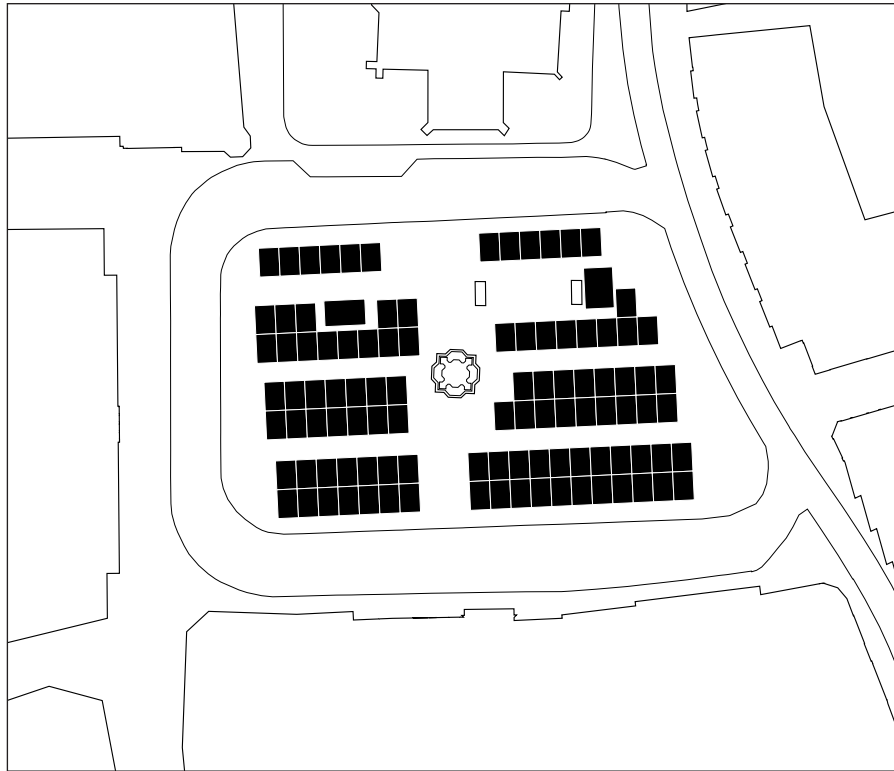

Existing

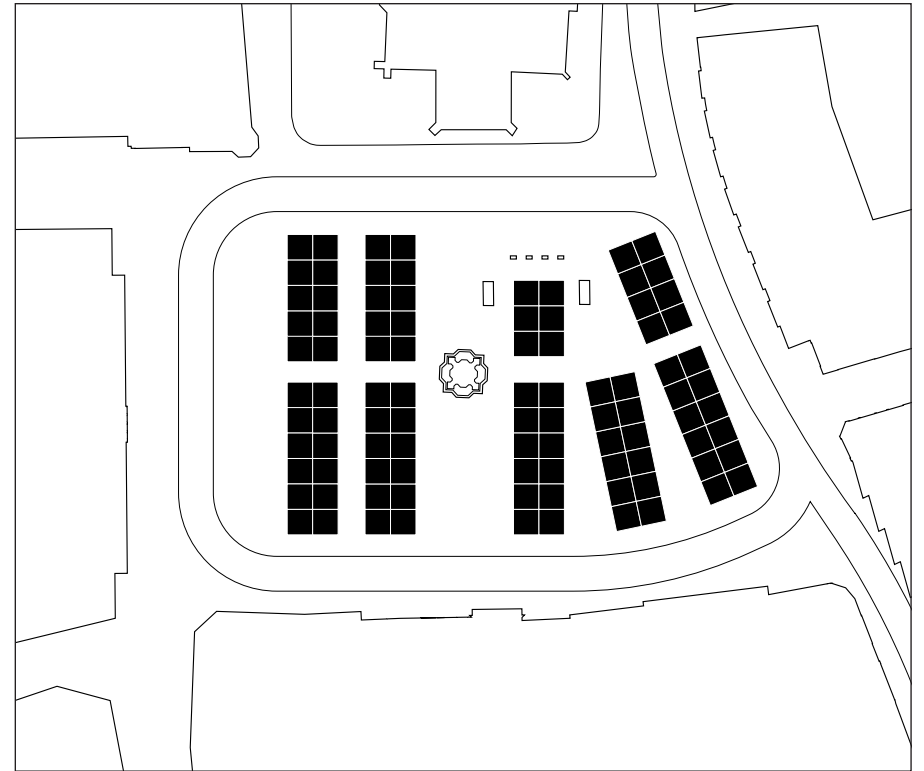

Proposed

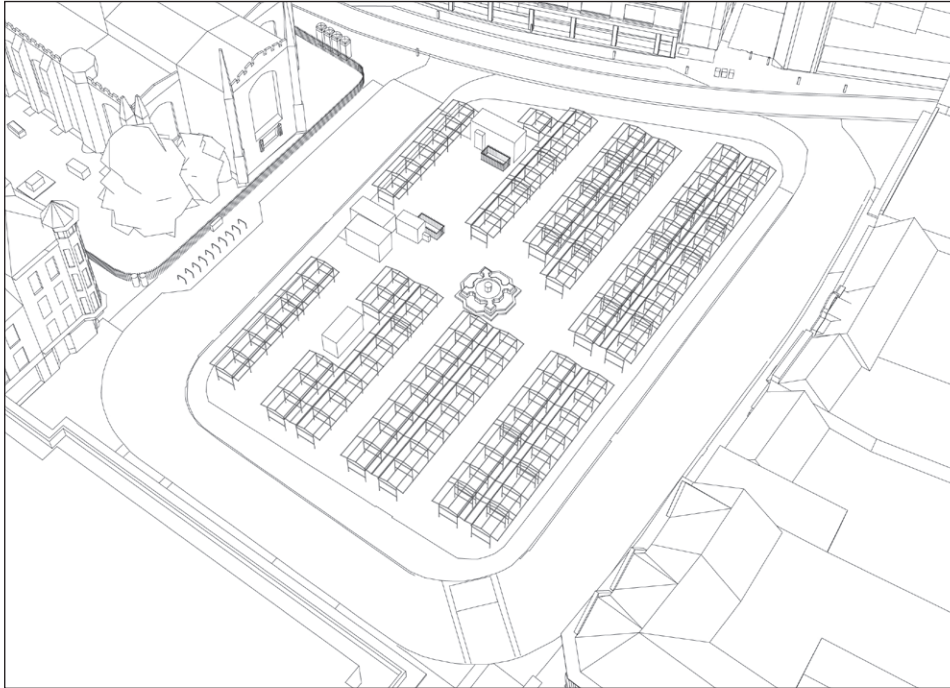

**Existing**

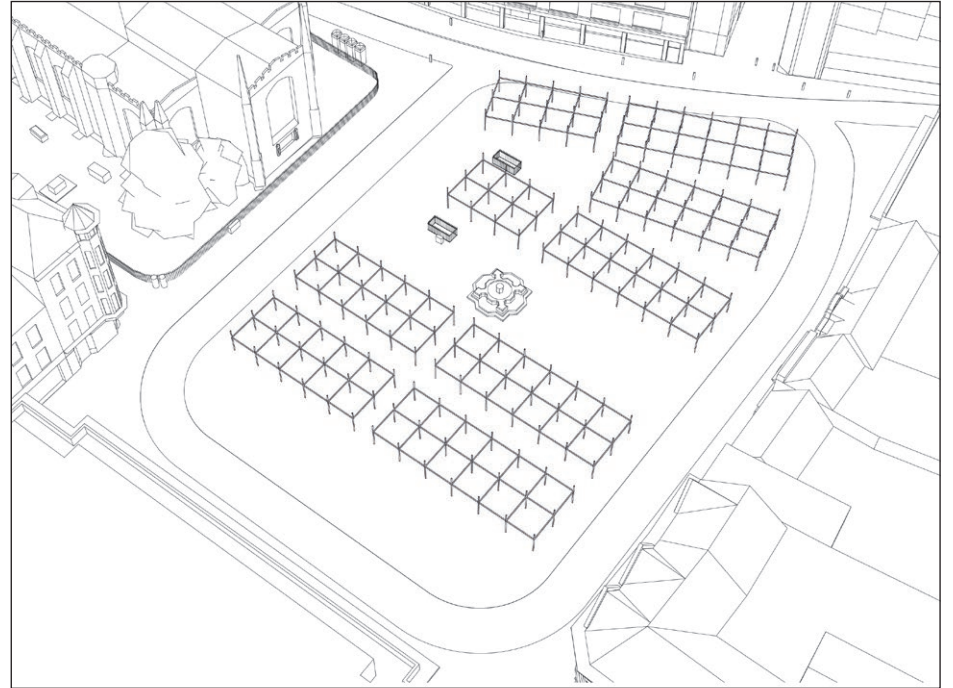

**Proposed**



# 3.0 Market Stall Design: Option A - Module

New, durable and demountable market stall design

Page 8

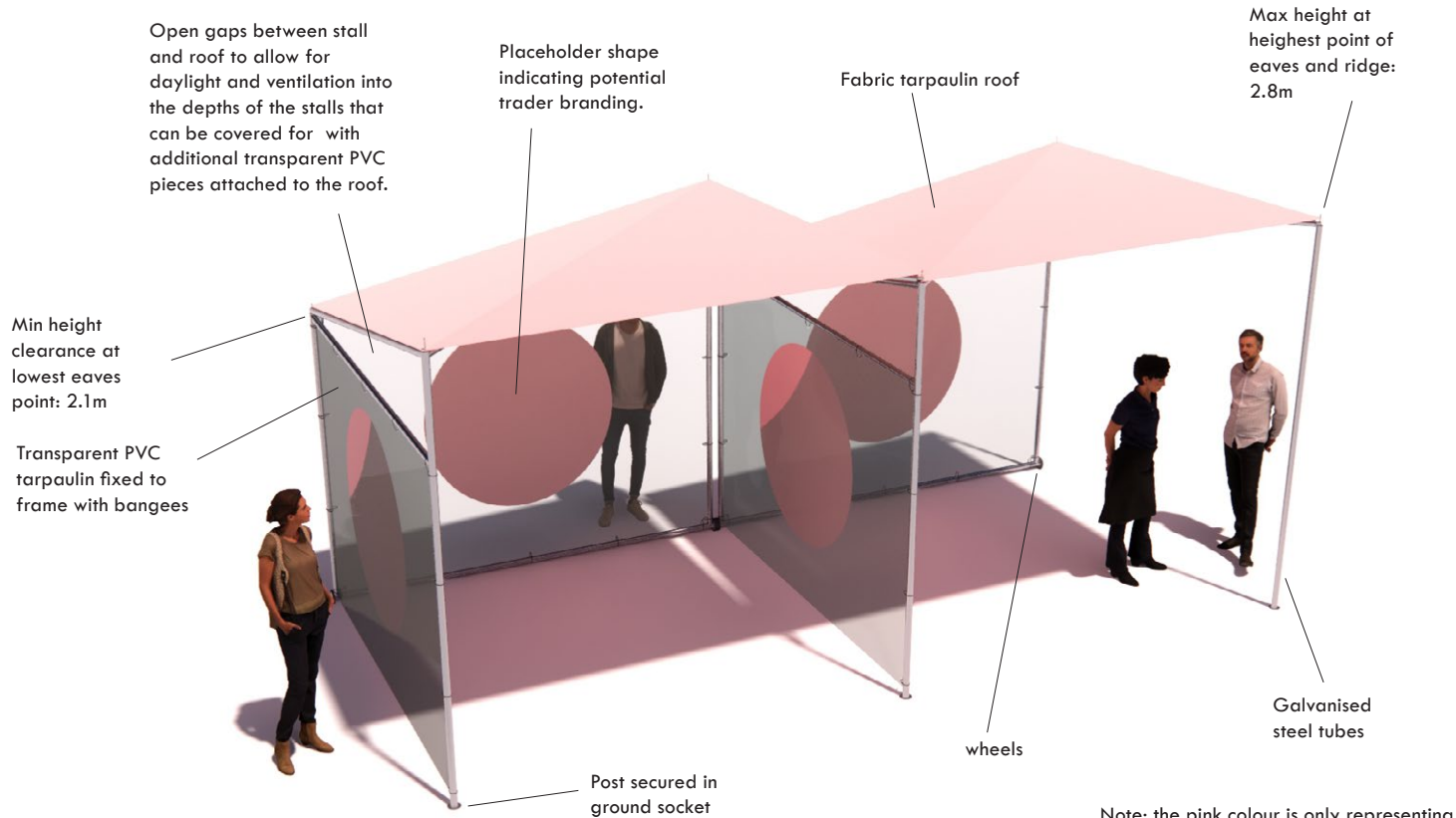

Option A - Module

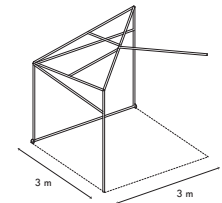

Frame

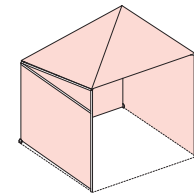

Unit

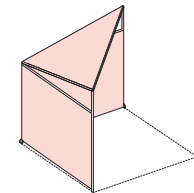

Folded

Note: the pink colour is only representing a non-white colour and is acting in this illustration as a placeholder, not a colour proposal for the stalls.



# Market Stall Design: Option A - Module

Page 9

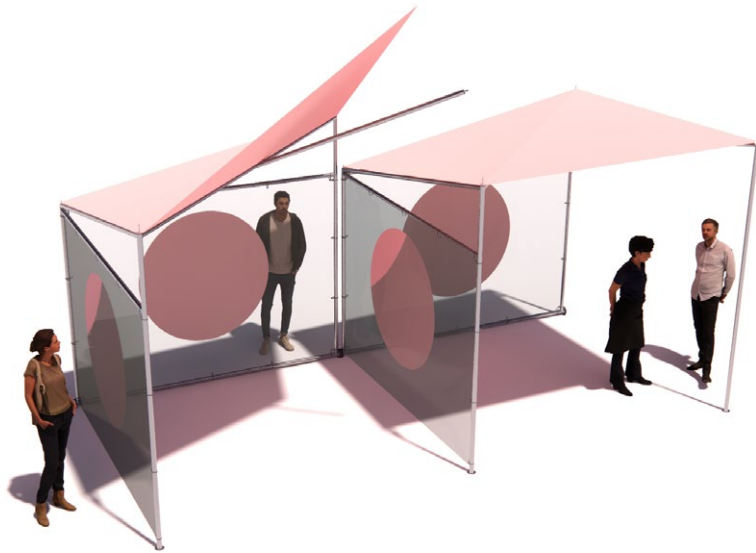

Unhooking and folding back of roof

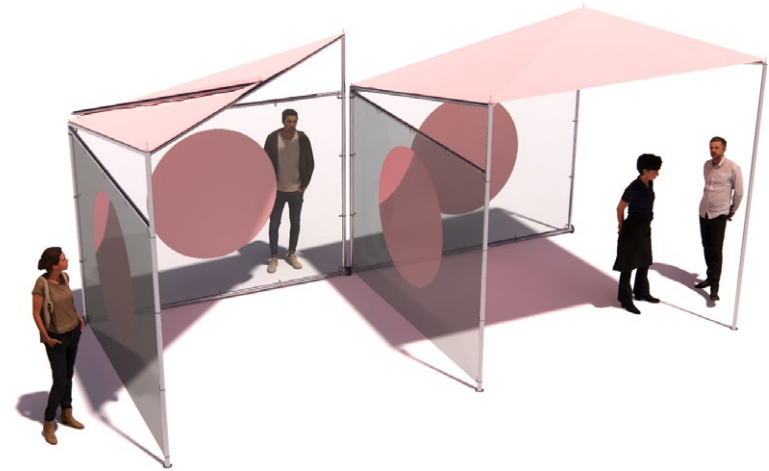

Stall fully folded into triangle shape

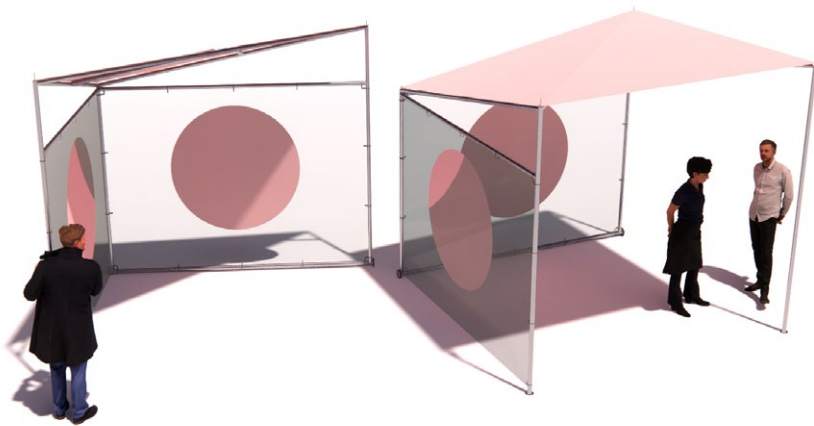

Stall lifted out of ground socket and wheeled away

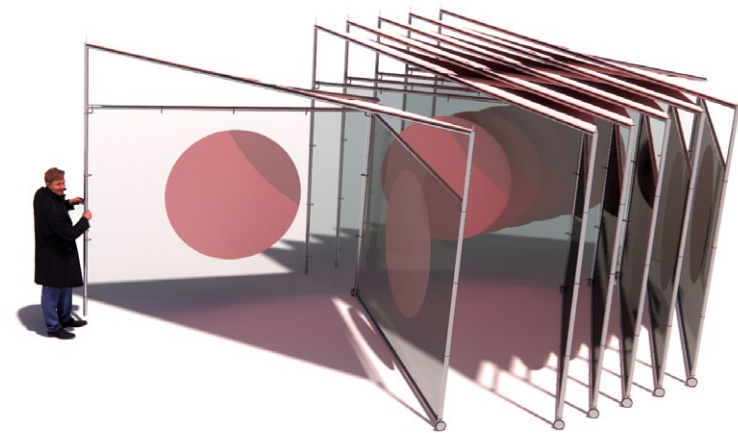

Stall wheeled into a stacked row of stalls for storing

# Market Stall Design: Option B - Frame

Page 10

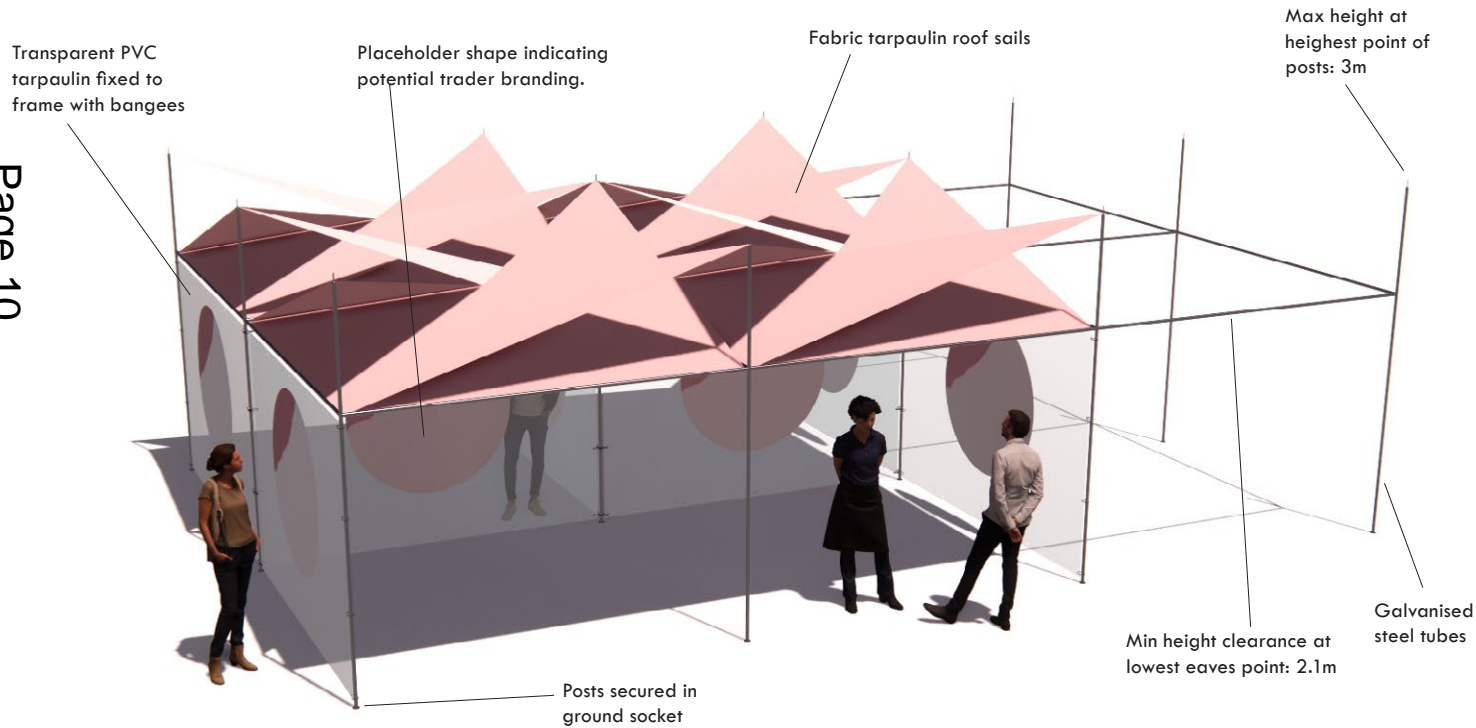

**Option B - Frame**

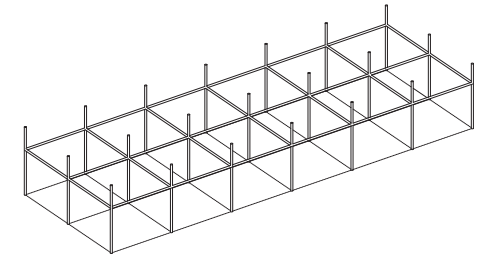

**Bare Frame**

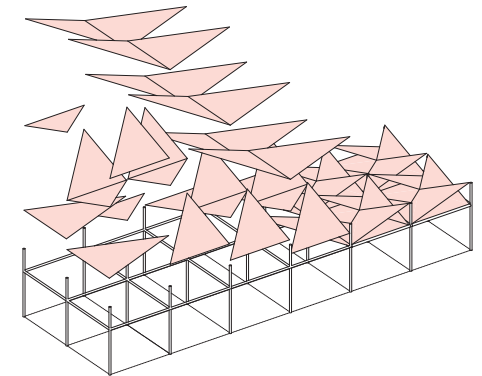

**Removing/adding roof sails**

Note: the pink colour is only representing a non-white colour and is acting in this illustration as a placeholder, not a colour proposal for the stalls.

# Market Stall Design: Option B

Page 11

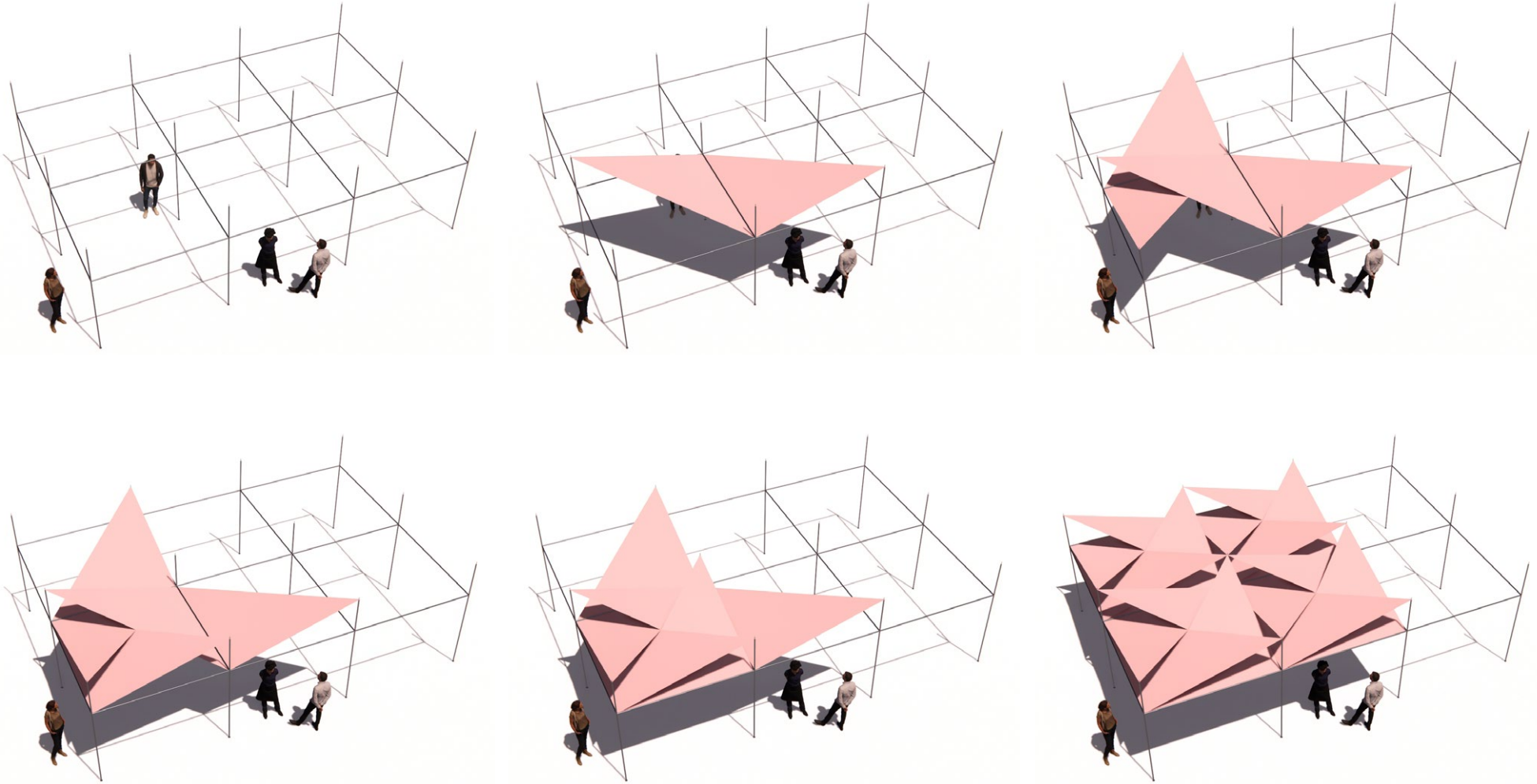

Sequence of roof sail weaving

# 4.0 Street Furniture and Seating

The street furniture proposals aim to create a coordinated and cohesive design that is considered and appropriate to the character of the square. Making the most of the space available by reducing clutter of unnecessary items and introducing more of what's lacking such as seating.

The proposals provide additional seating opportunities with a range of seating types. These include fragmented seating, long tables, long benches and seating blocks. They will cater for different uses such as for people that want a quick rest, somewhere to sit, relax and watch the world go by or to meet as a group and eat at a table.

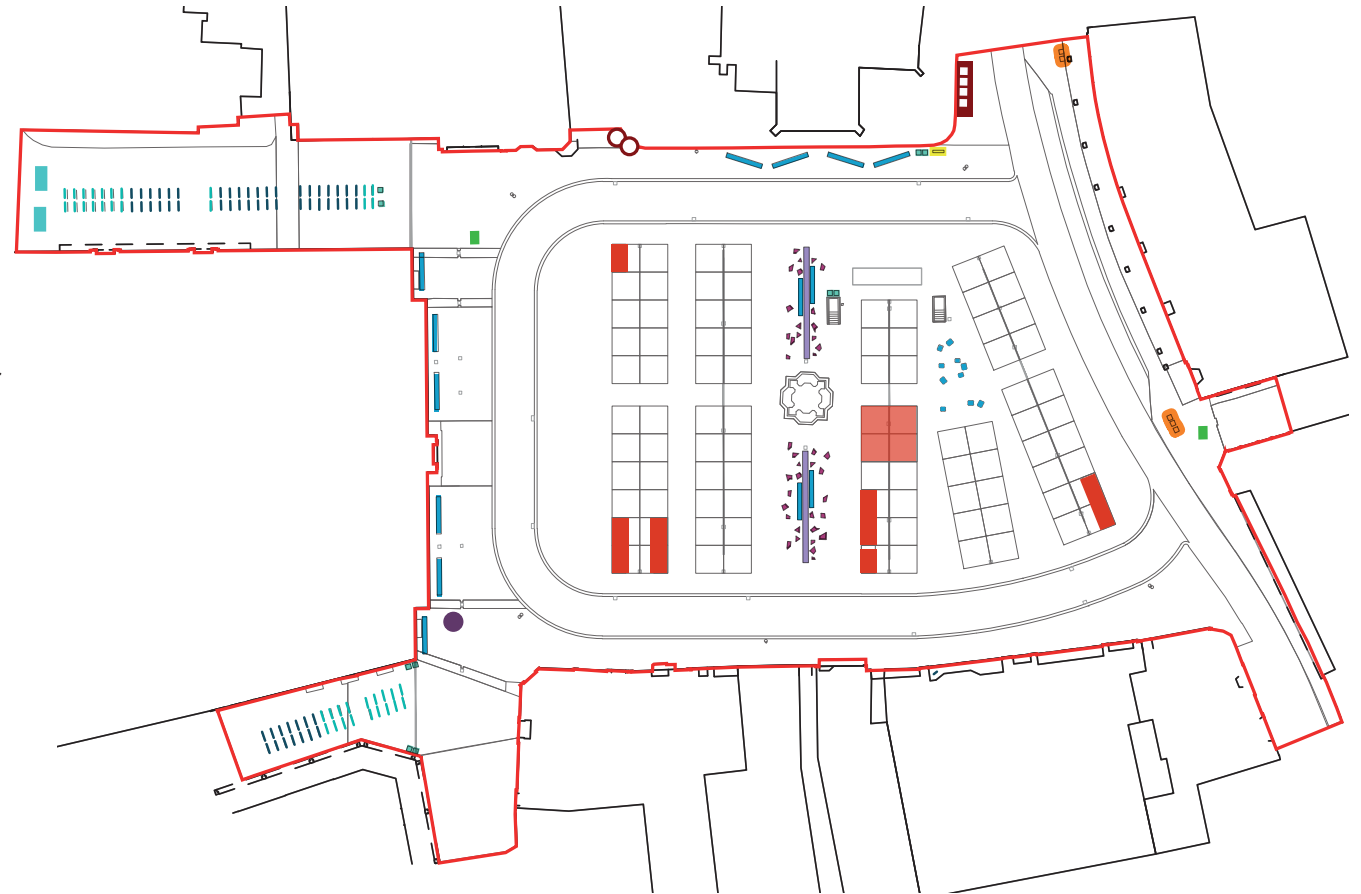

- | Existing Retained  | Proposed                               |
|--------------------|--|
| ● Memorial artwork | ■ Litter Bins and mixed recycling bins |
| ○ Post Boxes       | — Long Benches                         |
| ■ Telephone Kiosks | — Communal Table                       |
| Cycle Stands       | ⋯ Fragment Seating                     |
| ■ Sign             | ■ Market objects                       |
| ○ Litter bins      | ■ Fish Monger counter                  |
| ■ Seating          | Relocated cycle stands                 |
|                    | ■ Digital sign                         |

**Proposed**

# Seating Types

Page 13

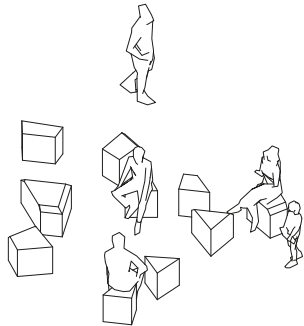
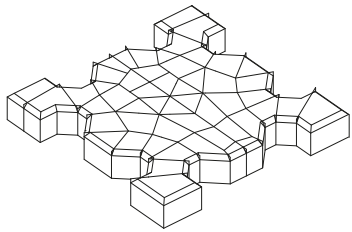
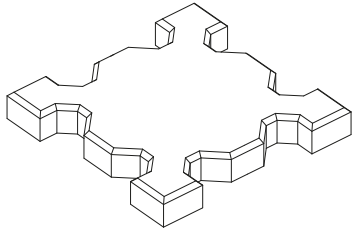

Fragmented seating concept

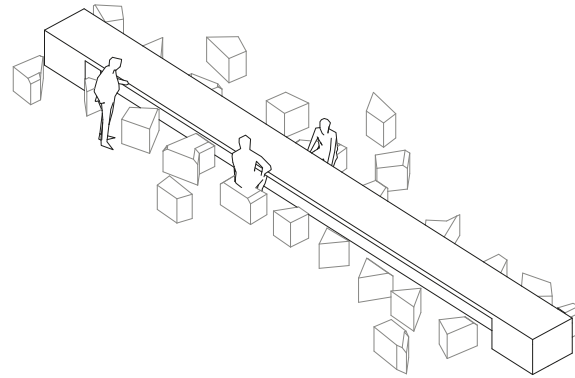

Long Table illustrative view

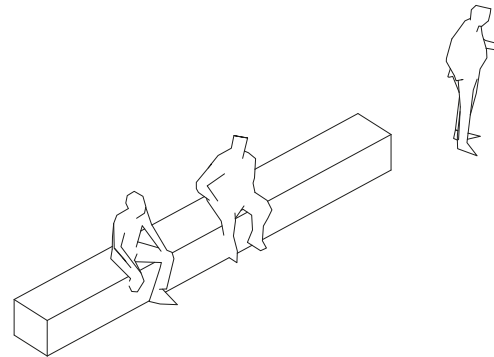

Long Benches illustrative view

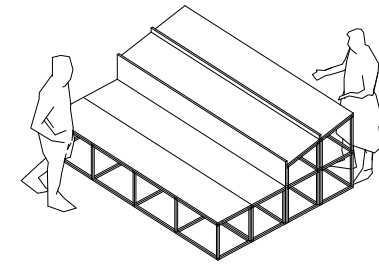

Objects as display stands

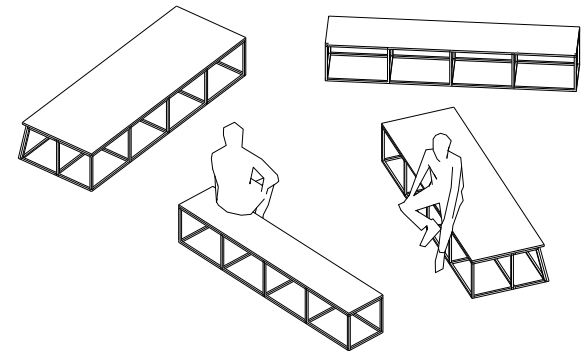

Objects as seating



View of the central seating area with Gt St Mary's in the background

## 5.0 Utilities: Waste

A new underground waste management system, improved toilets and storage for stallholders.

The proposal for the management of trade waste is to employ an underground collection system that replaces the existing above ground

bins, compactors and containers as well as increase the current capacity. The underground bin options being considered are a system already in operation in Eddington (NW Cambridge) or a lift system that allows existing large bins to be stored underground.



Bin collection system options



The Sotkon Max bins

# Utilities: Toilets + Storage

The existing underground toilet and storage space will be partially be employed to facilitate the underground waste system while maintaining some storage capacity and providing fully refurbished toilets and a communal amenity/ kitchenette area for the traders.

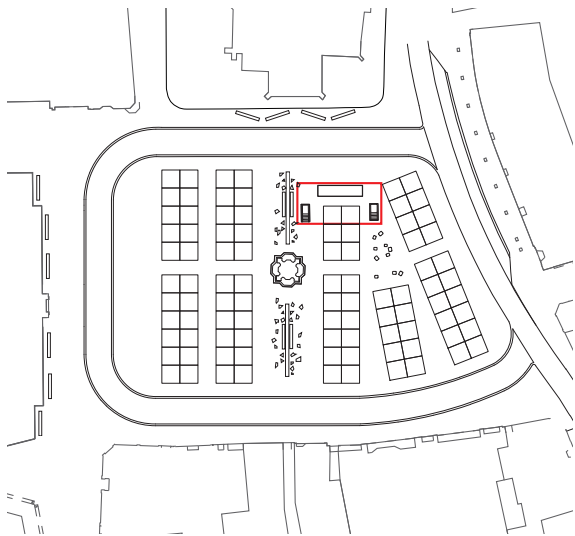

Location of existing underground space

Existing

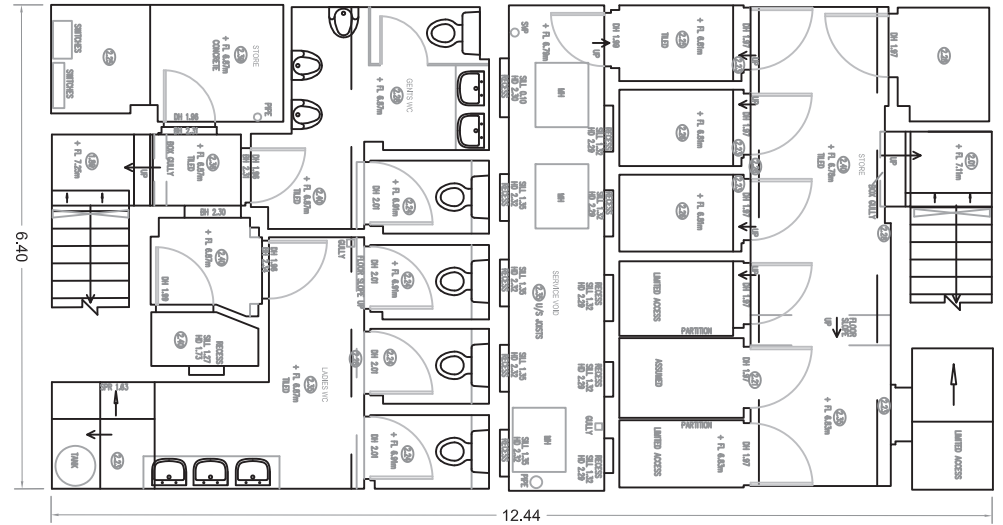

Proposed

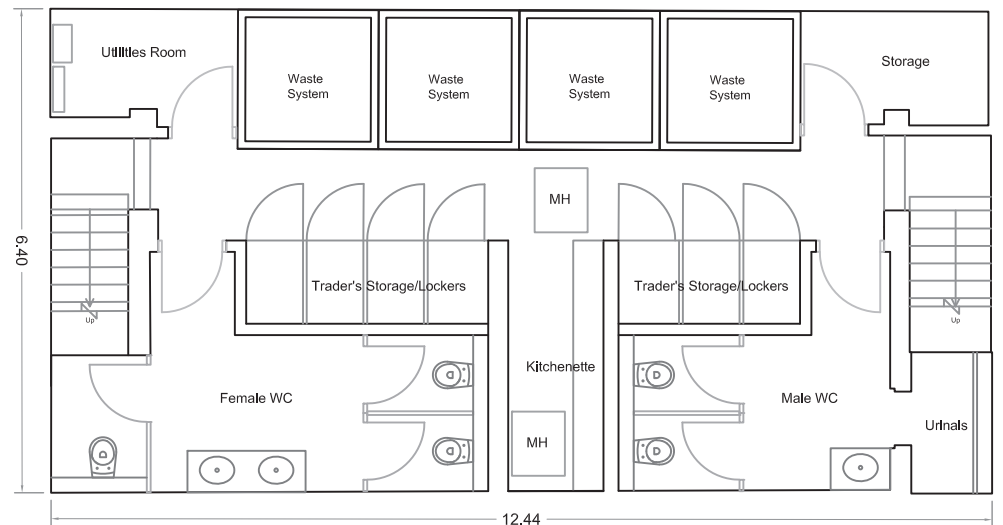



London  
New Fetter Place  
8-10 New Fetter Lane  
London EC4A 1AZ  
United Kingdom  
+44 (0) 20 7467 1470

Bristol  
Studio 4B  
36 King Street  
Bristol BS1 4DZ  
United Kingdom  
+44 (0) 117 203 3628

Cambridge  
17A Sturton Street  
Cambridge CB1 2SN  
United Kingdom  
+44 (0) 1223 949054

Exeter  
Kings Wharf, The Quay  
Exeter EX2 4AN  
United Kingdom  
+44 (0) 1392 260 430

Glasgow  
Sovereign House  
158 West Regent Street  
Glasgow G2 4RL  
United Kingdom  
+44 (0) 1412 229 780

Manchester  
Beehive Lofts  
Beehive Mill  
Jersey Street  
Manchester M4 6JG  
United Kingdom  
+44 (0) 161 359 5684

Oxford  
Worton Rectory Park  
Oxford OX29 4SX  
United Kingdom  
+44 (0) 1865 887050

Peterborough  
17 Minster Precincts  
Peterborough PE1 1XX  
United Kingdom  
+44 (0) 1733 310 471

[www.lda-design.co.uk](http://www.lda-design.co.uk)

LDA Design Consulting Ltd  
Registered No: 09312403  
17 Minster Precincts, Peterborough PE1 1XX

---

LDA Design is a ISO 9001 / ISO 14001 accredited company

This page is intentionally left blank